

CONFIDENTIAL

As for other languages the English or German text is translated faithfully without any change.
Wii_ACC_RemoteJacket_MAN_UKV_20070920

Removing the Wii Remote Jacket

Remove the Wii Remote Jacket as shown below.

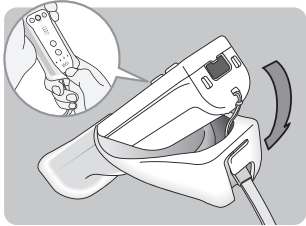

1 Pull off from the bottom

Pull the Wii Remote Jacket off from the base of the Wii Remote.

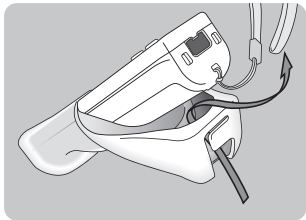

2 Pull out the Wii Remote Wrist Strap

Pull the Wii Remote Wrist Strap out through the hole in the Wii Remote Jacket.

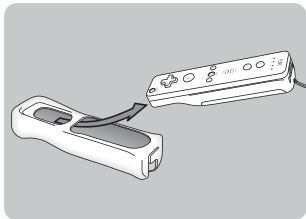

3 Remove the Wii Remote

Remove the Wii Remote from the Wii Remote Jacket.



Nintendo D-63760 Großostheim

AGES 8 AND UP.

Wii Remote Jacket conforms to:

- TOY Directive (88/378/EEC)



Nintendo UK
55-57 High Street, Windsor, Berkshire, SL4 1LP, U.K.
www.nintendo.co.uk

© 2007 NINTENDO. TM, ® AND THE Wii LOGO ARE TRADEMARKS OF NINTENDO.



RVL-A-JA-UKV

Wii Remote Jacket User's Manual



The Wii Remote Jacket (RVL-022) provides an additional enhancement. Using the Wii Remote Jacket will provide protection if the Wii Remote (RVL-003) is accidentally thrown or dropped during game play.

Use this jacket on the Wii Remote to help reduce the risk of damage to the Wii Remote or surrounding objects, or injury to other people, if you lose your grip on the Wii Remote.

For details, please refer to the Instruction Booklet for the game you are playing.

- Although the Wii Remote Jacket helps reduce the possibility of injury to people, or damage to objects, caused by improper handling of the Wii Remote, it does not eliminate it completely. Be sure to observe all cautions and warnings when using the Wii Remote.
- Do not deliberately knock the Wii Remote against the TV, furniture or other objects.
- Always use the Wii Remote Wrist Strap and keep a firm grip on the Wii Remote at all times during game play.
- Make sure there is sufficient distance between yourself and other people and objects when using the Wii Remote to avoid collisions.

Wii Remote with
the Wii Remote Jacket fitted

Wii Remote without
the Wii Remote Jacket

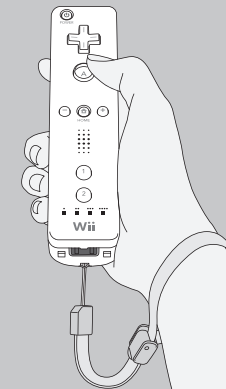
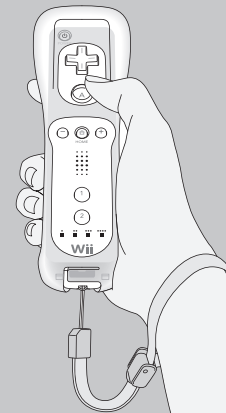

Fitting the Wii Remote Jacket

Fit the Wii Remote Jacket to the Wii Remote as shown below.

If this product is to be used by a young child, the Wii Remote Jacket should be fitted by an adult, taking care to ensure safety.

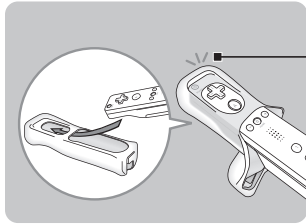

- 1 Insert the top of the Wii Remote**
Insert the top end of the Wii Remote into the Wii Remote Jacket.
Push it all the way inside the jacket.

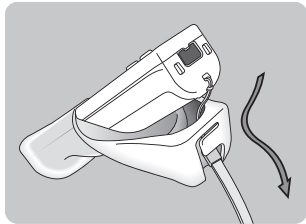

- 2 Thread the Wii Remote Wrist Strap through**
Thread the Wii Remote Wrist Strap through the hole in the bottom of the jacket from inside.

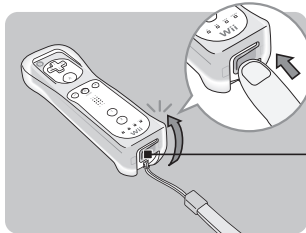

- 3 Pull on the jacket**
Taking care not to trap the Wii Remote Wrist Strap, pull the Wii Remote Jacket over the base of the Wii Remote and insert the connector cover on the jacket into the External Extension Connector on the Wii Remote.
Connector cover

Inserting batteries in the Wii Remote

The Wii Remote uses AA batteries. Nintendo recommends high-quality alkaline batteries for best performance and longevity of battery life. Be sure to insert the batteries correctly using the following procedure.

If this product is to be used by a young child, the batteries should be inserted by an adult.

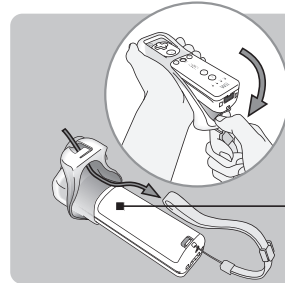

- 1 Remove the Wii Remote Jacket**
Pull the Wii Remote Jacket off the base of the Wii Remote, pull it up to expose the entire battery cover and pull the Wii Remote Wrist Strap out through the hole in the jacket.

Pull up to expose the entire battery cover.

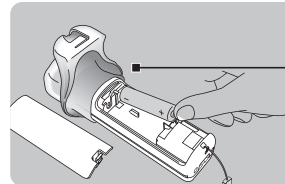

- 2 Insert the batteries**
Remove the battery cover and insert two AA batteries, making sure that you insert the minus (-) end first as shown in the illustration.
 - When removing the batteries, remove the plus (+) end first.

Insert the minus (-) end first.

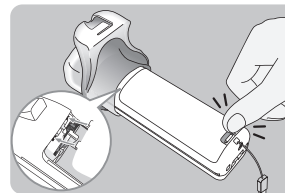

- 3 Replace the battery cover**
Ensure that the two catches on the battery cover are hooked firmly into the Wii Remote and push the cover down firmly until you hear it click, taking care not to trap the Wii Remote Wrist Strap.

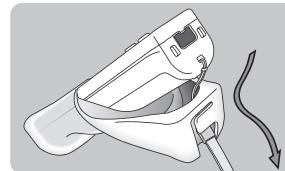

- 4 Replace the Wii Remote Jacket**
Thread the Wii Remote Wrist Strap through the hole in the bottom of the Wii Remote Jacket and pull the jacket back onto the Wii Remote.